

7 Characteristics and Dimensions

Molded Case Circuit Breakers

NF125-SEV
NF125-HEV
NF250-SEV
NF250-HEV



NF125-SEV

| Model | | NF125-SEV | | NF125-HEV | | NF250-SEV | | NF250-HEV | |
|---|-----------------------|--|------|--------------------|---------|----------------|---------|----------------|--|
| Rated current I _n (A) | | 32 63 125 | | 32 63 125 | | 160 250 | | 160 250 | |
| Current setting I _r (A) | | 16-32 32-63 63-125 | | 16-32 32-63 63-125 | | 80-160 125-250 | | 80-160 125-250 | |
| Number of poles | | 3 4 | | 3 4 | | 3 4 | | 3 4 | |
| Rated insulation voltage U _i (V) | | 690 | | 690 | | 690 | | 690 | |
| Rated short-circuit breaking capacity (kA) | IEC 60947-2 (Icu/Ics) | AC | 690V | 8/8 | 10/8 | 8/8 | 10/8 | | |
| | | | 500V | 30/30 | 50/38 | 30/30 | 50/38 | | |
| | | | 440V | 36/36 | 65/65 | 36/36 | 65/65 | | |
| | | | 415V | 36/36 | 70/70 | 36/36 | 70/70 | | |
| | | | 400V | 36/36 | 75/75 | 36/36 | 75/75 | | |
| | | | 380V | 36/36 | 75/75 | 36/36 | 75/75 | | |
| | | | 230V | 85/85 | 100/100 | 85/85 | 100/100 | | |
| Standard attached parts (front connection) | | Mounting screw: M4×0.7×55 (3P: 2pcs, 4P: 4pcs) Insulation barrier: (3P: 4pcs, 4P: 6pcs) | | | | | | | |

Operating Characteristics

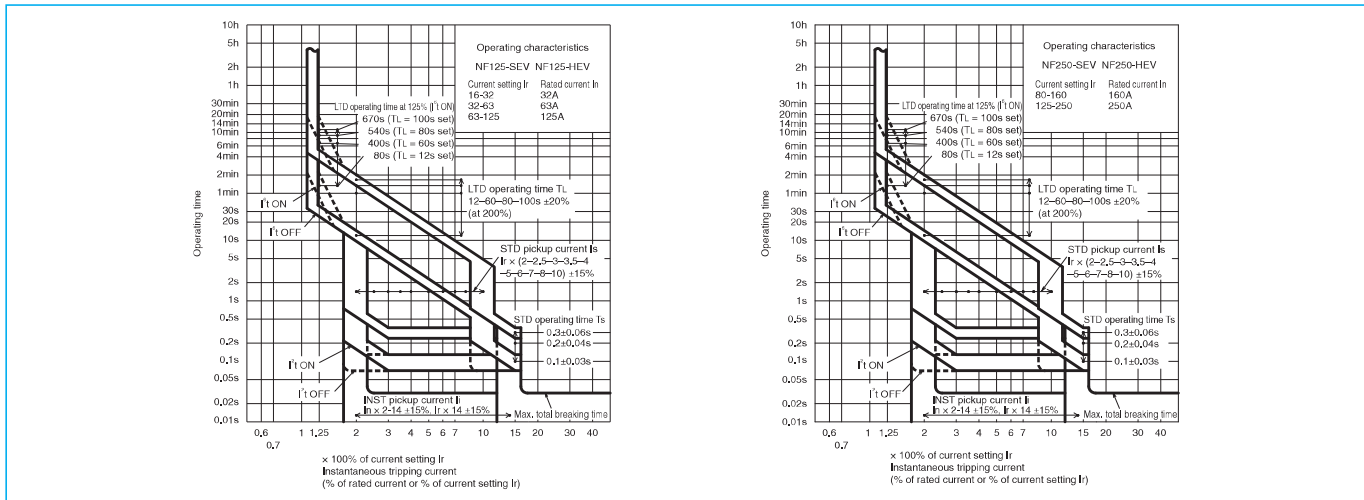

Internal Accessories

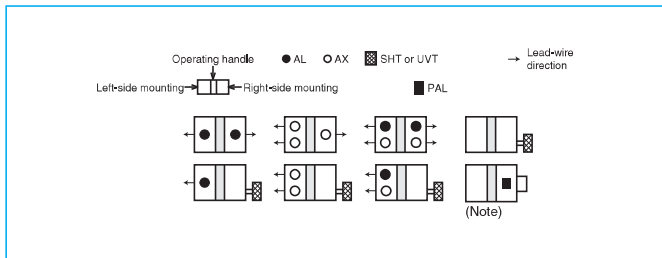

Current Reducing Curve

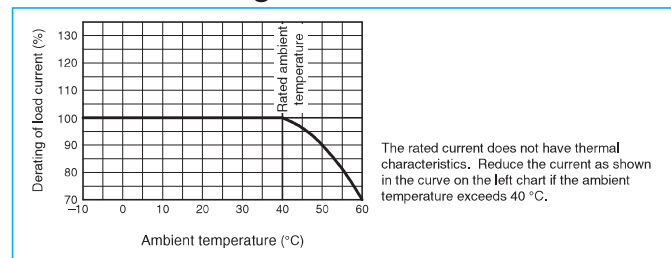

External Accessories

| Accessories | | Type name | Reference page | Accessories | | Type name | Reference page |
|-----------------------------|---------|-------------|----------------|----------------------|--------------|-------------|----------------|
| Operating handle | F | F-2SV | 119 | Mechanical interlock | MI | 3P MI-05SV3 | 131 |
| | V | V-2SV | 121 | | | 4P MI-2SV4 | |
| Handle lock device | LC | LC-05SV | 129 | Terminal cover | Small | 3P TC-S | TCS-2SV3 |
| | HL(*1) | HLF-05SV | | | | 3P TCL-2SV3 | |
| | | HLN-05SV | | | 3P TCL-2SV3L | | |
| | HLS-2SV | 4P TCL-2SV4 | | | | | |
| | | | 3P TTC-2SV3 | | | | |
| | | | 3P BTC-2SV3 | | | | |
| | | | 3P PTC-2SV3 | | | | |
| Electrical operation device | | | | | | (*2) | 135 |

Notes *1 HLF types are used for OFF lock and HLN types for ON lock.
 *2 Specify the working voltage. Refer to the reference page for type name.

Outline Drawing

Front connection

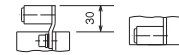
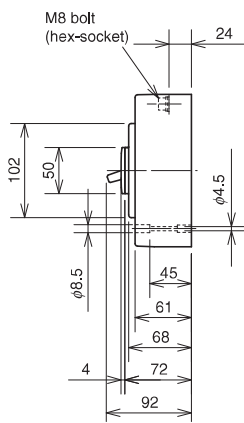
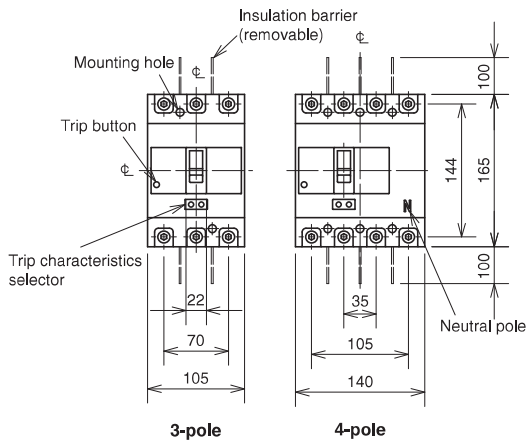

Solderless terminal for wire size
 125-175A 14-95mm²
 200-250A 70-125mm²
 Wire connection

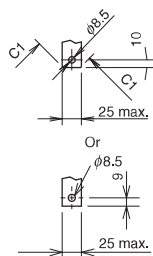

(Conductor thickness t=7 max.)

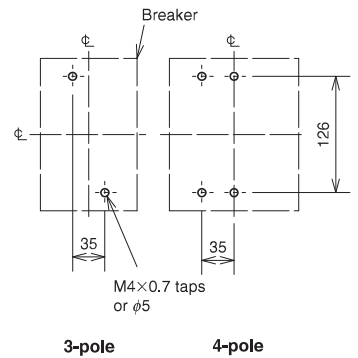

Conductor drilling for direct connection

Drilling plan

Rear connection

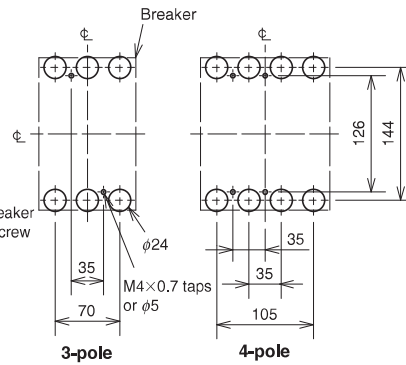
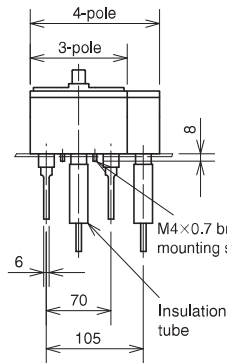
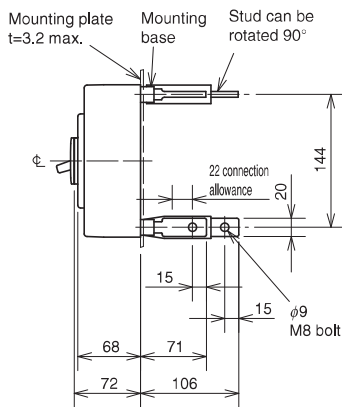

Drilling plan

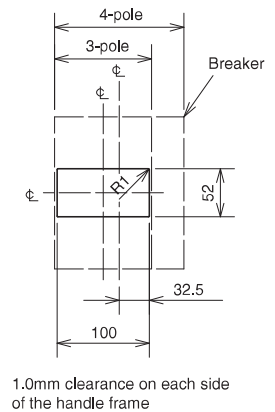

Front-panel cutout

Plug-in

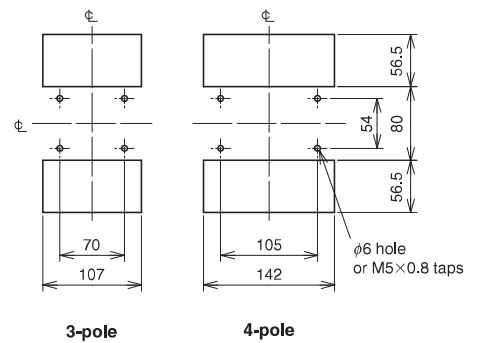
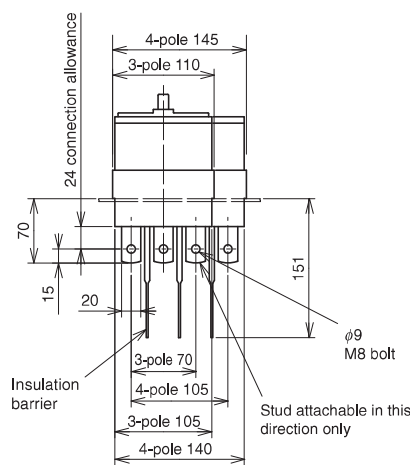
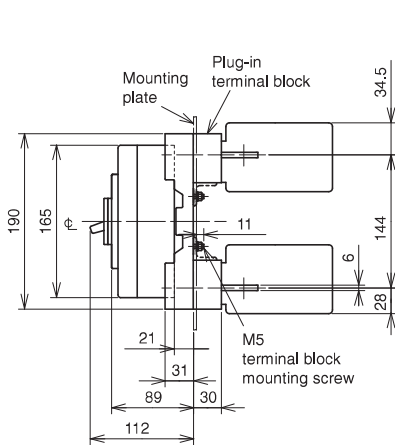

Drilling plan